

Soils Map

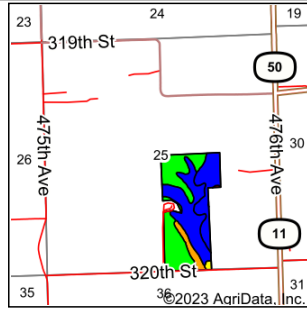

State: **South Dakota**
 County: **Union**
 Location: **25-92N-50W**
 Township: **Brule**
 Acres: **66.65**
 Date: **7/19/2023**

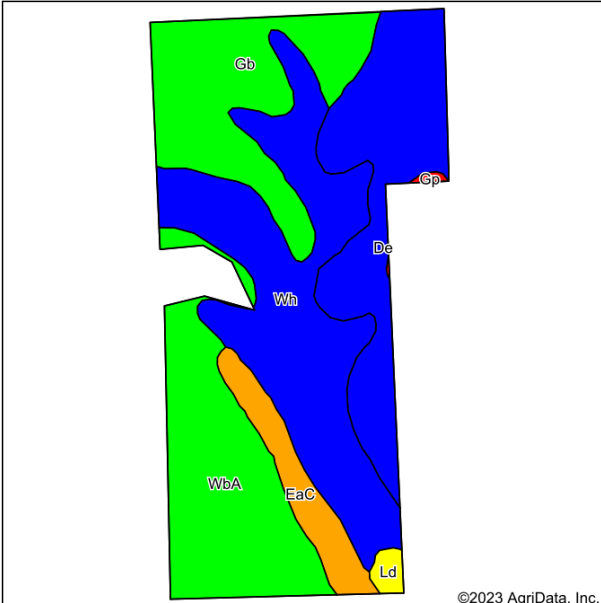

Soils data provided by USDA and NRCS.

©2023 AgriData, Inc.

© AgriData, Inc. 2023

www.AgriDataInc.com

Area Symbol: SD127, Soil Area Version: 26																					
Code	Soil Description	Acres	Percent of field	Non-Irr Class Legend	Non-Irr Class *C	Productivity Index	Alfalfa hay Tons	Barley Bu	Bromegrass hay Tons	Bromegrass alfalfa AUM	Bromegrass alfalfa hay Tons	Corn Bu	Corn silage Tons	Flax Bu	Grain sorghum Bu	Oats Bu	Soybeans Bu	Spring wheat Bu	Sunflowers Lbs	Winter wheat Bu	*n NCCPI Soybeans
Wh	Whitewood silty clay loam, 0 to 2 percent slopes, occasionally flooded	20.99	31.5%	■	Ilw	82	2	43	3.5	3.5		87	9.3		51	54	32	30	1340	32	73
WbA	Wentworth silty clay loam, 0 to 2 percent slopes	14.39	21.6%	■	I	93															66
De	Dempster silty clay loam	13.77	20.7%	■	Ils	65	3.1			4.2		75		23	58	78	30				56
Gb	Graceville silty clay loam, 0 to 2 percent slopes	12.68	19.0%	■	Is	83															68
EaC	Egan-Shindler complex, 6 to 9 percent slopes	4.06	6.1%	■	Ille	65	3.2			5.3		69			61	67	26				58
Ld	Luton silty clay	0.61	0.9%	■	IVw	63					3.4	80				44	27				50
Gp	Orthents, gravelly	0.15	0.2%	■	VIIIIs	0															20

Soils data provided by USDA and NRCS.

Maps Provided By:



© AgriData, Inc. 2023 www.AgrIDataInc.com

Code	Soil Description	Acres	Percent of field	Non-Irr Class Legend	Non-Irr Class *c	Productivity Index	Alfalfa hay Tons	Barley Bu	Bromegrass hay Tons	Bromegrass alfalfa AUM	Bromegrass alfalfa hay Tons	Corn Bu	Corn silage Tons	Flax Bu	Grain sorghum Bu	Oats Bu	Soybeans Bu	Spring wheat Bu	Sunflowers Lbs	Winter wheat Bu	*n NCCPI Soybeans
Weighted Average					1.69	79.7	1.5	13.5	1.1	2.3	*-	47.8	2.9	4.8	31.8	37.6	18.1	9.4	422	10.1	*n 65.8

*n: The aggregation method is "Weighted Average using all components"

*c: Using Capabilities Class Dominant Condition Aggregation Method